

- Fire Safety Key
- Fire Resistance
- Fire rating 30 minutes (R, E, I)
  - Fire rating 60 minutes (R, E, I)
  - Fire rating 120 minutes (R, E, I)
  - Potential additional fire rating
  - Fire / smoke curtain to lift
- Notes: R (Stability) - E (Integrity) - I (Insulation)
- Fire Doors
- FD60S
  - FD60
  - FD30S
  - Historic doors providing smoke retardancy during escape period
- Emergency Egress
- Place of refuge
- Fire Escape Lighting
- FD60S

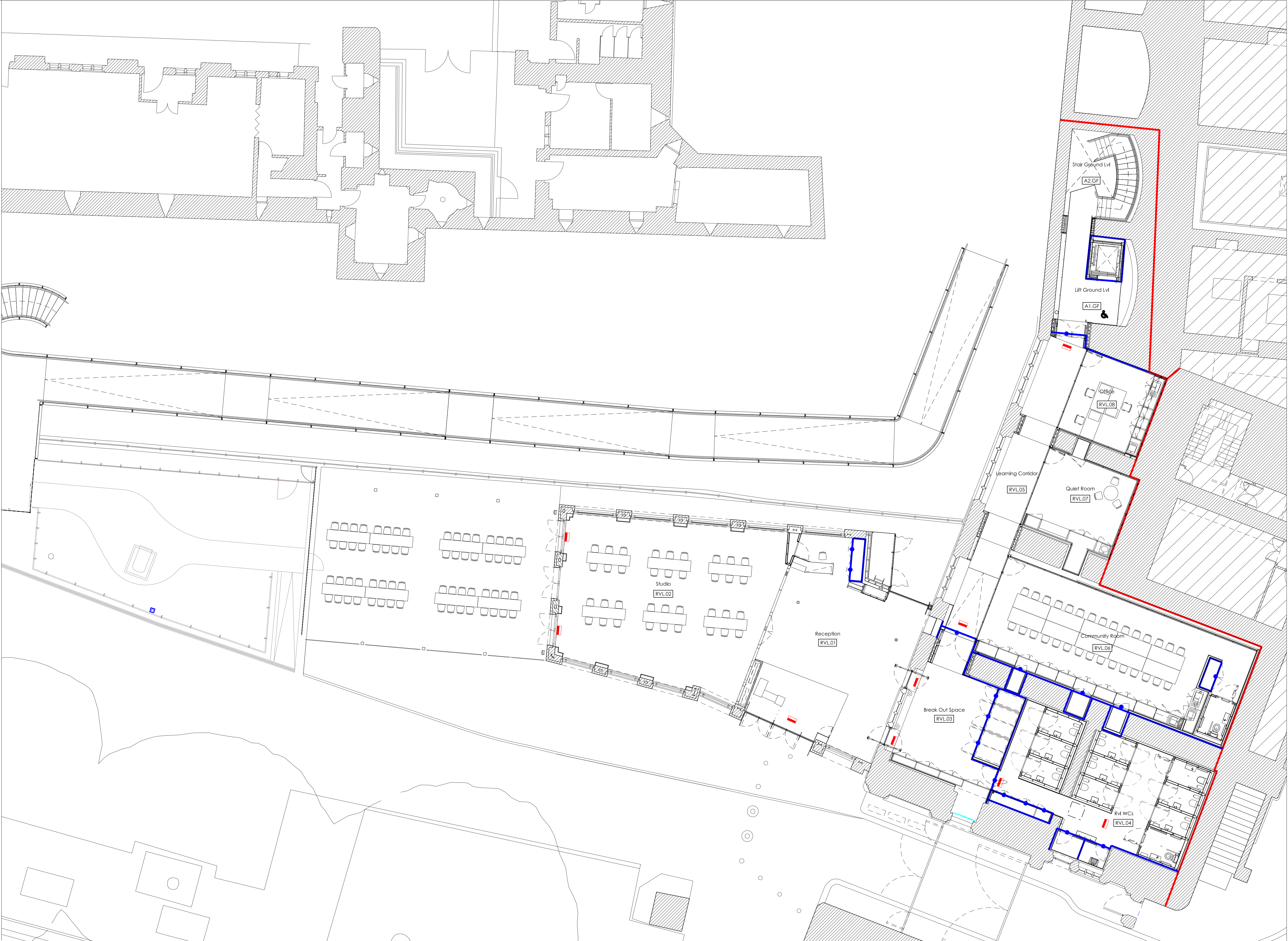

Tender DRAFT

Existing Fabric

General Notes:

To be read in conjunction with Service Engineer, Structural Engineers and Heritage Architects information.

All demolition and proposed works are to be undertaken in adherence to SMC conditions and Listed Building Consent conditions.

**Jamie Fobert**  
— Architects

Rochelle, 22 Club Row  
London E2 7EY  
T: +44 (0) 207 553 6560  
mail@jamiefobertarchitects.com

Copyright of Jamie Fobert Architects Ltd 2023

Unless indicated below, this drawing is for information only.  
Do not scale. Use figured dimensions only. All dimensions to be checked on site.

Issue/Revision	Date	Rev	Subject	Reveller Proposed Fire Ground Floor Plan
Stage 4	18 07 25	A	Scale	1:100
Tender Draft	24 10 25	B	Original Size	A1
			Date	06 06 25
			Drawing No.	TOL -JFA-01-00-DW-A-1161